



where local fare meets local excellence



## SAVOR... WILMINGTON CATERING

Some of the best cuisine comes from the North Carolina coast, and SAVOR... Wilmington Catering by SMG is no exception. Our award-winning chef and the SAVOR... Wilmington staff embody a collaborative spirit of passion, innovation, service and fine Southern dining. We source only the freshest foods and support local farmers when creating specialty menus. Whether you're planning a banquet, reception, wedding or corporate gathering, SAVOR... Wilmington Catering is dedicated to your event success and culinary vision.

SAVOR... Wilmington Catering by SMG is the exclusive caterer for the Wilmington Convention Center.

- Imaginative cuisine and gracious hospitality
- In-house food & beverage kitchen
- Custom-designed menus to meet all needs and tastes
- From cocktails and hors d'oeuvres to elegant five-course meals
- Create a tailored package for your event

www.BusinessMadeCasual.com  
910.251.5101

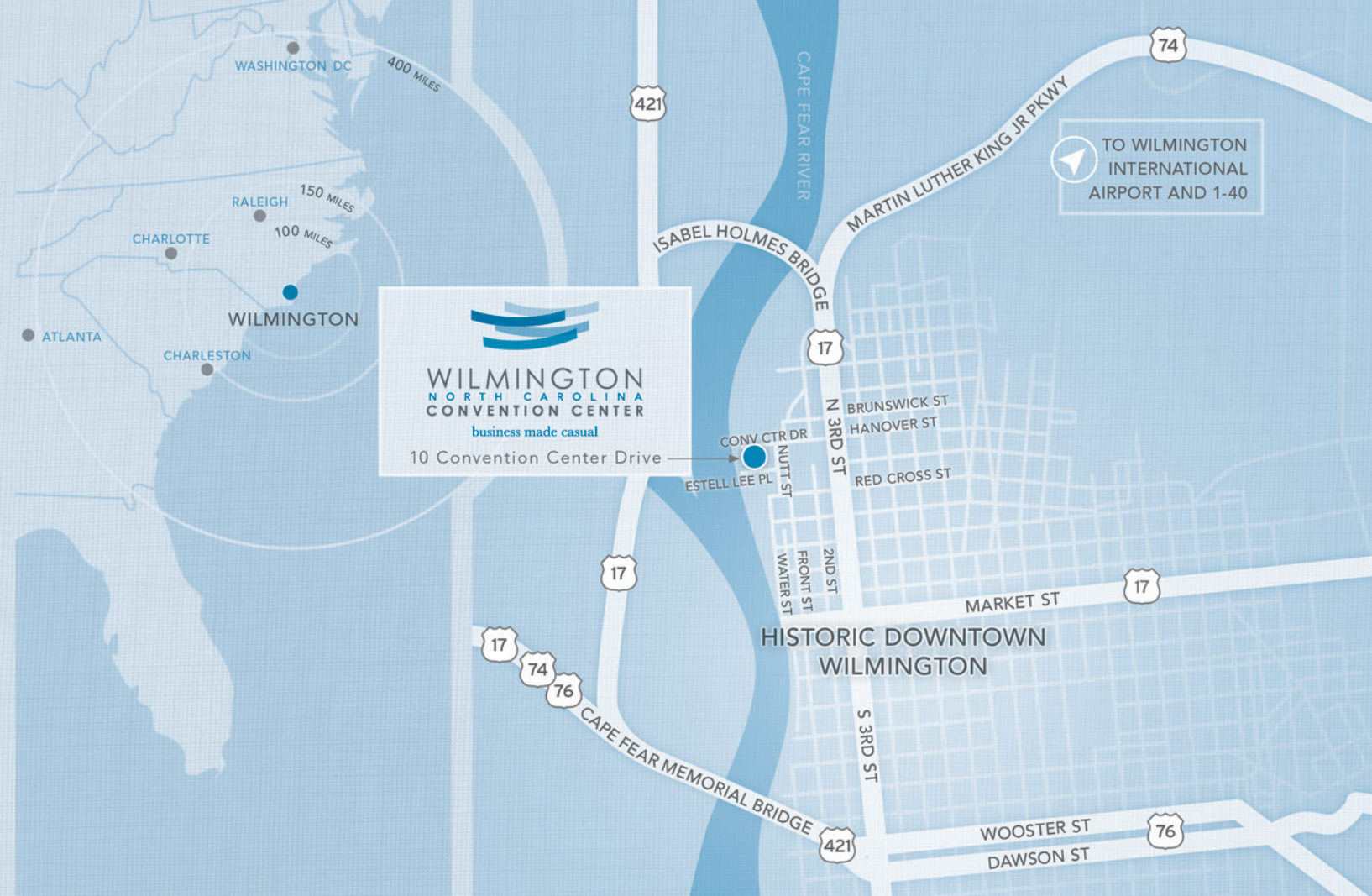

where historic views meet new perspectives



In the southeastern corner of the North Carolina coast sits Wilmington — a picturesque port city nestled between the Cape Fear River and the Atlantic Ocean. Stroll our two-mile Riverwalk and experience Wilmington's historic cobblestone-lined downtown streets, more than 200 restaurants, nearby hotels, shops and attractions; all full of Southern hospitality.

Take time to explore and relax with your toes in the sand while taking advantage of the city's close proximity to three colorful island beaches including Carolina, Kure and Wrightsville. The area is also home to nearly 8,000 hotel rooms and suites with unique settings stretching from the river to the sea. There's something for everyone in Wilmington year-round.

www.BusinessMadeCasual.com  
910.251.5101

GPS ADDRESS: 515 NUTT STREET, WILMINGTON NC 28401 • PHYSICAL ADDRESS: 10 CONVENTION CENTER DRIVE, WILMINGTON NC 28401



where fresh air meets fresh ideas



WILMINGTON  
NORTH CAROLINA  
CONVENTION CENTER

business made casual

www.BusinessMadeCasual.com  
910.251.5101





## where a relaxed space inspires a productive pace

The Wilmington Convention Center is the largest convention center on the North Carolina coast, boasting 107,000 square feet of unique function space. Sustainable design, maritime inspired art as well as grand views overlooking the Cape Fear River all capture the essence of business made casual.

With convention and event capabilities for 25 to 2,000 in a variety of meeting and exhibit spaces, the building offers the ideal venue for any gathering. Enjoy the coastal breeze on our 12,000-square-foot event lawn and experience the perfect backdrop of historic charm and Southern hospitality.

- Floor to ceiling windows with idyllic riverfront setting and 30-foot ceilings
- Sleek maritime décor inspired by the Cape Fear River and Wilmington's port city history
- Flexible, comfortable space for meetings, trade shows, conventions, weddings or military balls
- Full in-house SAVOR Catering by SMG
- 578-space attached parking deck
- ADA accessible and LEED Silver Certified
- Nearly 8,000 hotel rooms and suites nearby

### SPACE CAPACITIES

SPACE	DIMENSIONS	SQ. FT.	CEILING HT.	THEATER	CLASSROOM	BANQUET	
Grand Ballroom	118' x 100'	11,800	15' 6"	1,508	684	800	
One Salon (A, B, C, D, E, or F)	51' x 33'	1,683	15' 6"	208	126	80	
Two Salons (A/B, B/C, D/E, or E/F)	51' x 66'	3,366	15' 6"	404	264	180	
Three Salons (A/B/C or D/E/F)	51' x 100'	5,100	15' 6"	672	396	320	
Center Corridor	15' x 99'	1,485	15' 6"	-	-	-	
Center Corridor plus A/B/C or D/E/F	66' x 100'	6,600	15' 6"	832	528	380	
Meeting Room 101	28' x 19'	508	12' 9"	49	26	30	
Meeting Room (1) 102, 103, or 104	28' x 14'	400	12' 9"	38	24	20	
Meeting Rooms (2) 103/104	55' x 14'	775	12' 9"	67	48	40	
Meeting Room 105	23' x 25'	565	13' 9"	58	30	40	
Meeting Rooms (1) 106, 107, or 108	30' x 39'	1,170	15' 6"	150	72	60	
Meeting Rooms (2) 106/107 or 107/108	60' x 39'	2,340	15' 6"	320	208	150	
Meeting Rooms (3) 106/107/108	90' x 39'	3,510	15' 6"	450	320	210	
Ticket Office	14' x 27'	378	12' 7"	38	20	20	
SPACE	EXHIBIT BOOTHS	DIMENSIONS	SQ. FT.	CEILING HT.	THEATER	CLASSROOM	BANQUET
Exhibit Hall	150	211' x 143'	30,173	30'/19"	2,596	1,600	1,750
SPACE	6' TABLETOP	DIMENSIONS	SQ. FT.	CEILING HT.	RECEPTION		
River Concourse	14	24' x 170'	4,080	15' 6"	up to 700		
Marina Concourse	16	19' x 394'	7,486	15' 6"	up to 1,400		
Nutt Street Concourse	11	11' x 135'	1,485	15' 6"	up to 200		
SPACE	DIMENSIONS	SQ. FT.	CEILING HT.	THEATER	CLASSROOM	BANQUET	
Outdoor Event Lawn	73' x 162'	11,826	-	1,400	-	750	

All capacities to maximum set based on in-house furniture allowing 8 feet in front of room for standing lectern. Banquet capacities are based on 72" rounds with 10 seats/table. Classroom capacities are based on 18" by either 6' and/or 8' tables with 3 or 4 seats/table respectively.

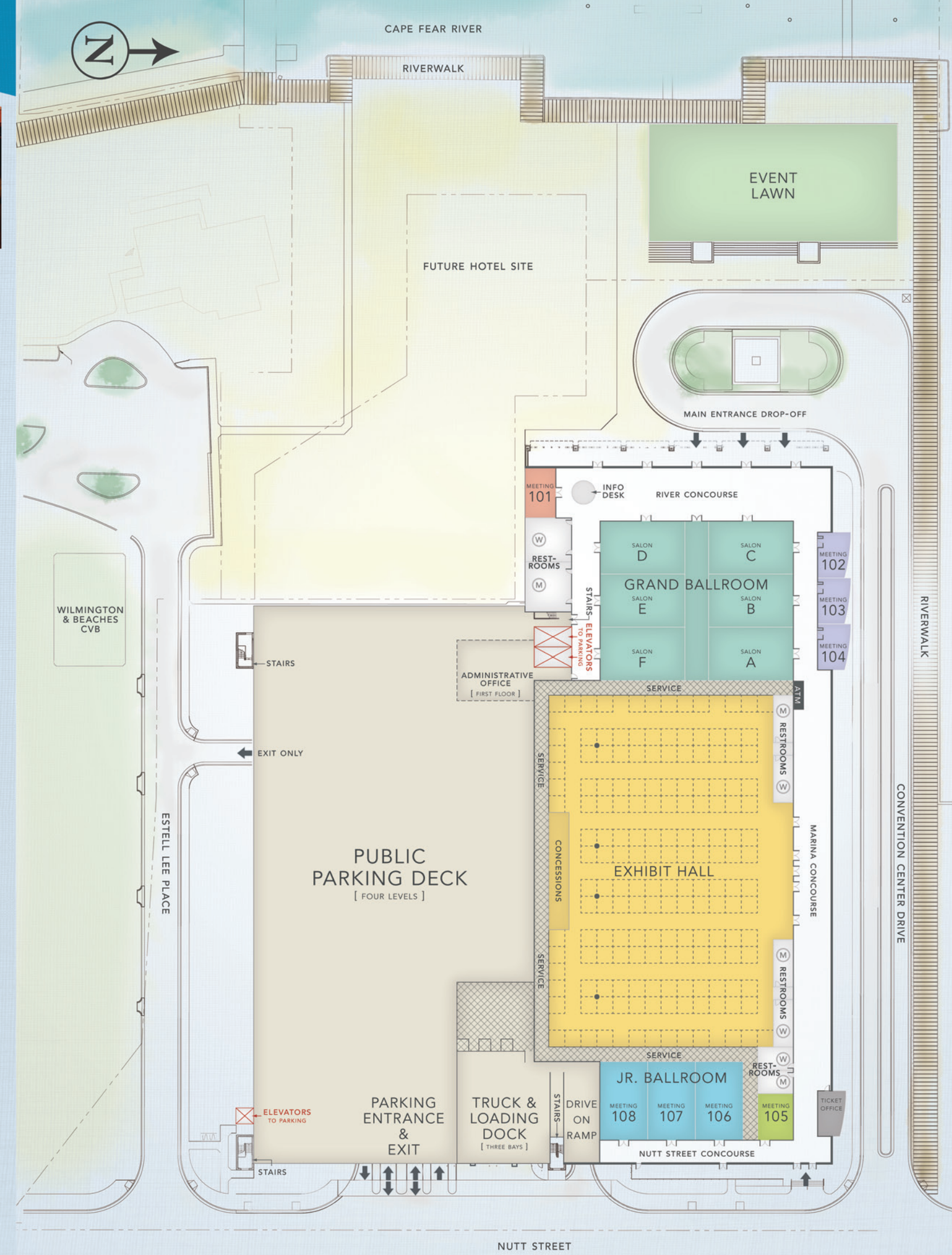

PHYSICAL ADDRESS: 10 CONVENTION CENTER DRIVE, WILMINGTON NC 28401  
MAILING ADDRESS: PO BOX 1379, WILMINGTON NC 28402 • FAX NUMBER: 910-251-5102



TO PLAN YOUR NEXT CONVENTION, CALL  
**910.251.5101**  
www.BusinessMadeCasual.com

IMAGES COURTESY OF:  
City of Wilmington  
Diane Gayton  
Harry Taylor Photography  
indigosilver studio  
Lynn Seldon