

# ARLINGTON CONVENTION Center

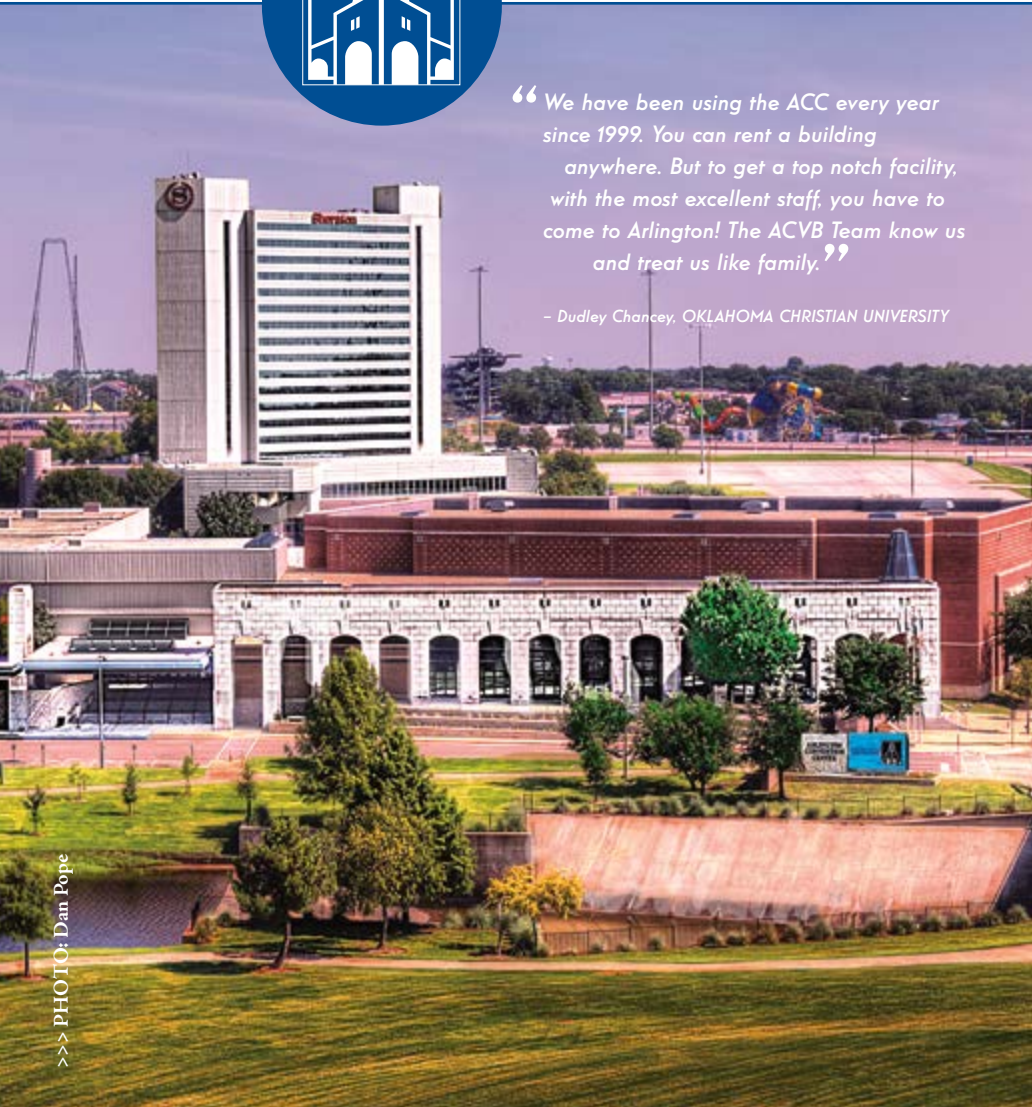

“ We have been using the ACC every year since 1999. You can rent a building anywhere. But to get a top notch facility, with the most excellent staff, you have to come to Arlington! The ACVB Team know us and treat us like family.”

– Dudley Chancey, OKLAHOMA CHRISTIAN UNIVERSITY



>>> PHOTO: Dan Pope

## TOP 10 ACC FACTS

- 1. Located in the heart of the Arlington Entertainment District
- 2. Designed for ease of access for efficient set-up and teardown
- 3. Built to handle significant electrical, utility and communications needs
- 4. Dramatic views of AT&T Stadium, Six Flags Over Texas and Globe Life Park
- 5. 90,000 sq.ft., all on one level, including Exhibit Hall, Grand Hall, and Meeting Rooms
- 6. Free public wifi available throughout the facility
- 7. Beautiful walking trails around the ACC
- 8. 10 minutes from DFW International Airport
- 9. Award-winning chef and catering
- 10. Open space 50,000 sq.ft. of column-free exhibit floor



# ARLINGTON CONVENTION Center

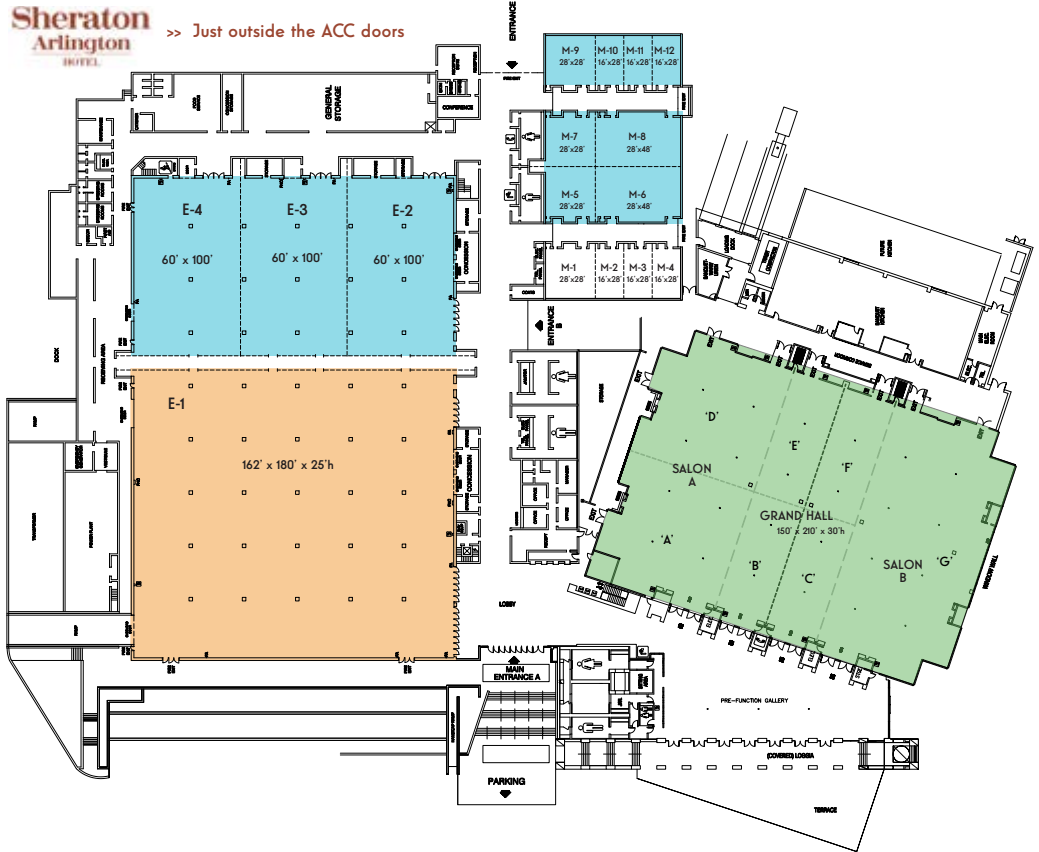

## THE GRAND HALL

30,000 sq.ft. of flexible, column-free carpeted space that provides an impressive backdrop and is divisible for banquets, meetings and events.

- 6,000 sq.ft. indoor pre-function gallery
- Outdoor waterfront terrace
- 30-foot ceilings
- More than 100 hang points
- Separate three bay truck dock

## THE EXHIBIT HALL

48,600 sq.ft. of column-free space for up to 276 10'x10' booths, seating for 5,000 theater-style or 2,800 in a banquet format.

- 30-foot utility centers throughout the show floor
- More than 1,000 pounds per sq.ft. floor load factor
- Two drive-in access doors
- Separate six bay truck dock
- Expansive 25-foot ceilings

GRAND HALL	Function Room	Square Feet	Ceiling Height	Theatre	Classroom Seating	Banquets	Exhibit Booths 10 x 10
	Grand Hall	30,000	30'	3,000	1,500	1,800	150
	Salon A	15,000	30'	1,500	650	770	70
	Salon B	15,000	30'	1,500	650	770	70
	Gallery	6,000	22'				
Terrace	4,700						

EXHIBIT HALL	Function Room	Square Feet	Ceiling Height	Theatre	Classroom Seating	Banquets	Exhibit Booths 10 x 10
	E- (1-4)	48,600	25'	5,000	3,900	2,800	276
	E-1	29,160	25'	2,800	2,400	1,500	157
	E-2	6,000	25'	670	500	320	32
	E-3	6,000	25'	670	500	320	32
E-4	6,000	25'	670	500	320	32	

## MEETING ROOMS

Complementing the Exhibit Hall and the Grand Hall is an additional 8,500 square feet of divisible meeting space available for breakout sessions or smaller meetings. Up to 12 separate meeting rooms, each offering individual climate, lighting and sound controls. Also available are dedicated internet and telephone services.

MEETING ROOMS	Function Room	Square Feet	Ceiling Height	Theatre	Classroom Seating	Banquets
	M1	784	10'	72	40	48
	M2	448	10'	49	30	24
	M3	448	10'	49	30	24
	M4	448	10'	48	30	24
	M5	784	12'	72	40	48
	M6	1,344	12'	144	80	96
	M7	784	12'	72	40	48
	M8	1,344	12'	144	80	96
	M9	784	10'	72	40	48
	M10	448	10'	49	30	24
	M11	448	10'	49	30	24
M12	448	10'	48	30	24	